

Waverley Gardens, Etchinghill, Rugeley, WS15 2YE

£280,000

3 1 2



- NO UPWARD CHAIN
- GAS CENTRALLY HEATED
- UPVC DOUBLE-GLAZED
- POPULAR SOUGHT AFTER LOCATION

Approx Gross Internal Area
101 sq m / 1092 sq ft

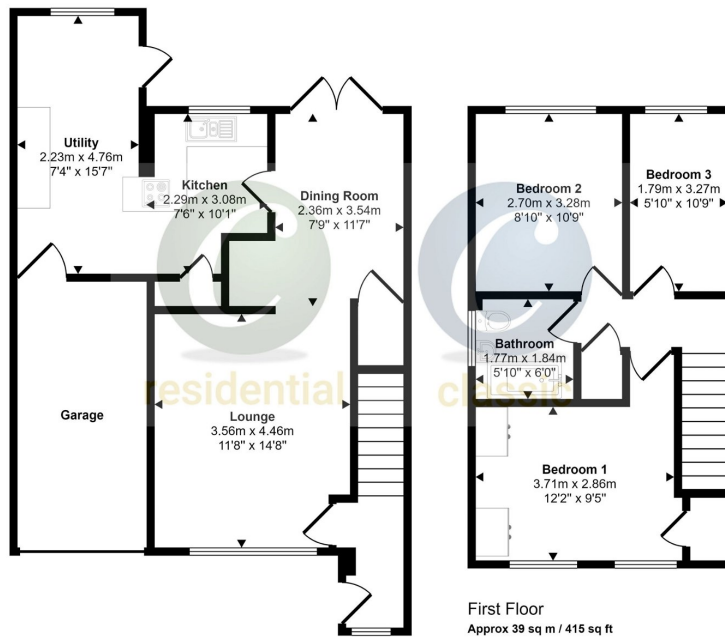

Ground Floor
Approx 63 sq m / 678 sq ft

This floorplan is only for illustrative purposes and is not to scale. Measurements of rooms, doors, windows, and any items are approximate and no responsibility is taken for any error, omission or mis-statement. Icons of items such as bathroom suites are representations only and may not look like the real items. Made with Made Snappy 360.

***** ONLINE VIRTUAL 360 TOUR AVAILABLE ON THIS PROPERTY - why not take a peek before booking a viewing please click on the link ***** C residential are pleased to market this link-detached Family Home in the popular area of Etchinghill. Offered with NO UPWARD CHAIN and benefiting from UPVC double-glazing and Gas central heating. Entrance Hall, Lounge, Dining Room, Extended Kitchen. First Floor Landing with Three Bedrooms and Bathroom. SINGLE GARAGE with landscaped gardens. EPC rating to follow